

# Little Barcelona

Assignment 5  
Group 4  
Diane, Irving, Lily,  
Mariana, and Natasha

A slice of Davis that represents a vision of sustainable living through active and public transportation, mixed-use development, and vibrant street life.

## Mission

To foster a collaborative, community and ecologically oriented environment while allowing the City of Davis to reduce its need for further expansion for years to come.

## Goals

- Building Community and Placemaking Opportunities (B) (D)
- Creating and Maintaining Site Health for All (A) (C)
- Providing and Incentivizing Alternative Transportation (E)

## Legend

Green space	Communal green space
Road	Water Feature
Parking	Study Rooms
Walk path	Car-free street
Mixed-use	Site Boundary
Family housing	Existing Railroad Tracks
Garden Beds	Trees
Community and engagement center	



Building Footprints (3 story) = 840,000 sq. ft.  
Building Footprints (4 story) = 240,000 sq. ft.  
Building Units = 730  
Parking Spots = 357  
Energy Value (\$) = 1,867,186



A

### Habitat Restoration

The arboretum increases biodiversity, provides habitat for different wildlife species, and acts as a communal & education space for people.



B

### Mixed-Use Space

The mixed-use area provides a car-free zone for a vibrant community space, local amenities for community needs, and affordable housing for low-income students.



C



D

### Rooftop Activation

A combination of a green roof, rooftop solar, and community gathering space provides a unique gathering space for residents.



E

### Transportation Circle

Various transportation methods besides a vehicle option to navigate through, around, and from Little Barcelone will be available, with alternative modes of transportation incorporated into the urban design.

### Air & Noise Pollution Barrier

The natural green barrier and flower wall will efficiently filter impurities in the air and minimize vehicle noise surrounding the site.

## Ecotour Map

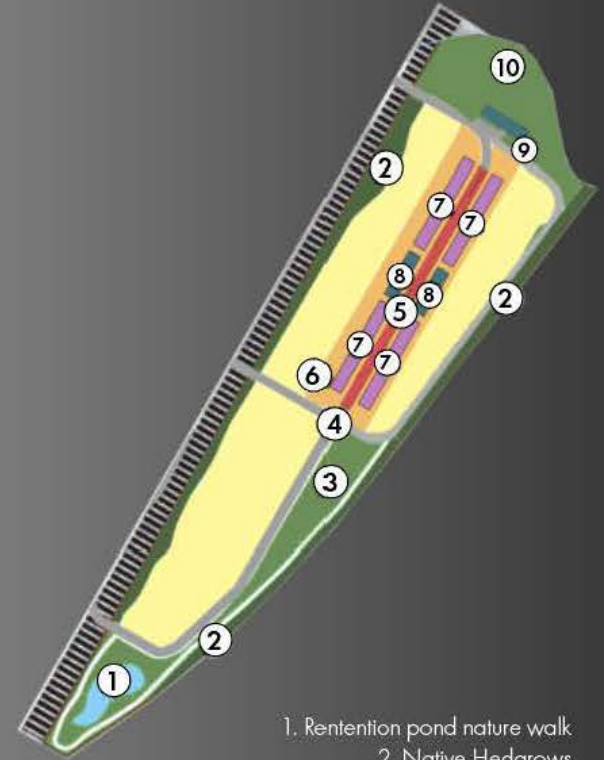

1. Retention pond nature walk
2. Native Hedgrows
3. Native Garden Maze
4. Multimodal transit stop
5. Pedestrian and bike way
6. Mixed-use development with courtyard gardens
7. Rooftop activation with solar and green roofs
8. Community engagement and support centers
9. Arboretum education center
10. Putah Creek Restoration Site